



[www.MosquitoCurtains.com](http://www.MosquitoCurtains.com)  
 770-645-4745 (direct)  
 866-622-0916  
 support@mosquitocurtains.com

# Worksheet

## Curtain Panels

Color \_\_\_\_\_  
*Black, White, or Ivory*

Mesh \_\_\_\_\_  
*Heavy Mosquito, No-see-um*

	<u>Width (ft-in)</u>	<u>Height (in)</u>
Panel 1	_____	_____
Panel 2	_____	_____
Panel 3	_____	_____
Panel 4	_____	_____
Panel 5	_____	_____
Etc...	_____	_____

## Sketches / Notes

## Tracking Hardware *(if tracking attachment)*

	<b>Quantity</b>
7ft straight tracks	_____
90-degree curve	_____
135-degree curve	_____
Track splices	_____
Tracking end caps	_____
Extra carriers <i>(if you loose some, later)</i>	_____

## Attachment Items *(for securing curtain)*

	<b>Quantity</b>
Marine snaps <i>(packs of 10)</i>	_____
Block shaped magnets	_____
Extra strength ring magnets	_____
Fiberglass Rods	_____
Elastic cord	_____

## 10 Principles To Remember

1. Most Velcro® tape attached orders use an outside hang because you can utilize the natural structure of support columns and any railings you may have while maximizing usable porch space.
2. Tracking attachment commonly uses an inside hang especially for curtain panels that turn a corner because they swag prettier. Think about how your curtain will look both open and closed.
3. Side bindings that meet at a support column both hide the seam and can be secured to the support column using marine snaps.
4. Curtain panels need to be a bit wider than your actual exposure for protective overlap.
5. Do not end panels at irregularly-shaped CORNER columns. Instead, let the panel turn the corner and seal to another panel using magnets. Panels can meet at non-corner irregularly shaped columns.
6. You should try to minimize the number of panels as the curtain is very pretty when it is seamless and you have less to seal. One or two exits are generally sufficient and you'll save on cost.
7. Masonry such as brick or stucco, can stress the netting fabric, so begin and end panel at masonry support columns and walls so only the sturdy binding can be directly exposed to masonry. Review
8. Consider right-angle straight tracks instead of curved track, if you plan to swag the curtain to a particular corner where the curtain panel turns that same corner. Review
9. The most overlooked items when ordering are fiberglass rods (2 per panel) and marine snaps.
10. Obstructions such as rain downspouts can be avoided with a panel split on either side of the obstruction.

## Preparing Your Online Order

### **Tracking attachment hardware**

- Curtains less than 124 inches tall should order standard tracking
- Taller orders should use heavy tracking
- Straight tracks are 7ft in length and can be cut with a hacksaw
- Splices join track lengths together
- Add 90-degree and 135-degree curved tracks if required
- End caps lock terminal track ends to contain carriers

### **Attachment items to seal your curtain**

- We strongly recommend ordering 2 fiberglass rods for each panel
- Remember to order sufficient marine snaps
- Elastic cord is a must for panels that turn a corner using an inside hang.
- Block-shaped magnets seal panel-to-panel doorways. Order in pairs spaced every 12-24"
- If your panels are not rectangular you must phone in your order. *Have diagram ready*
- If you need special assistance, email us 2 digital photos of your project.
- Be sure to include your name and telephone number on any thing you send to us!
- If your panels are rectangular you may order directly online

# Measure Entire Project Exposure

## 1. Create a project diagram

The top diagram is an aerial view of a 3-sided exposure

- Use the perspective that you are inside your space looking out so we can agree on "Left vs. Right " ...Important
- From this interior perspective, lay your entire project out on a sheet of paper like a Left-to-Right timeline
- Use dashed lines to represent outer corners of your project

## 2. Add measurements

- Write down the widths of each of the 3 sides in ft-in (i.e. 7-5 means 7ft 5in)
- Circle the heights at each corner represented in inches

### Sloped Floors

- Often concrete and tile floors are sloped for drainage so measure the height at all corners. If a floor slope is less than 2 inches, use the taller of the two heights and consider your panels to be rectangular.

### Shed Roof (pitched along sides)

- Your project might not be rectangular like this shed roof So be sure to measure the height at all corners

### Steep slope with tracking attachment

- Tracking a steep slope is problematic since you must either draw the curtain uphill or downhill where it will dump on the floor.
- You can insert a lightweight header beam horizontally that is tall enough not to sag like an upright 2x4 or 2x6 depending on the width of the space.
- We Velcro the triangle above the beam and track the rectangle below the beam.

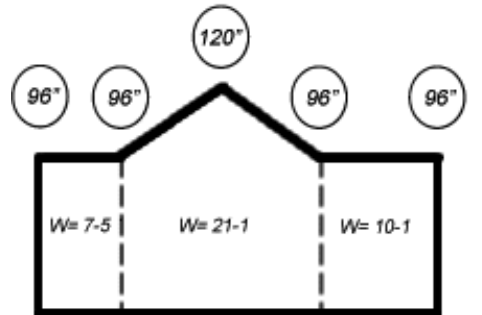
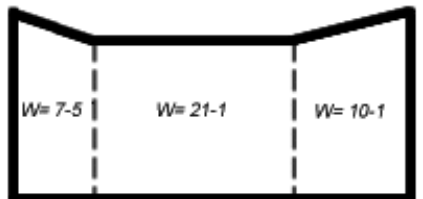
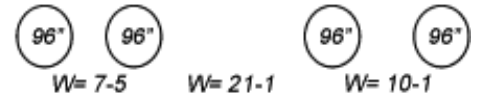
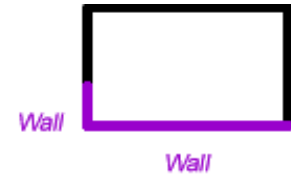
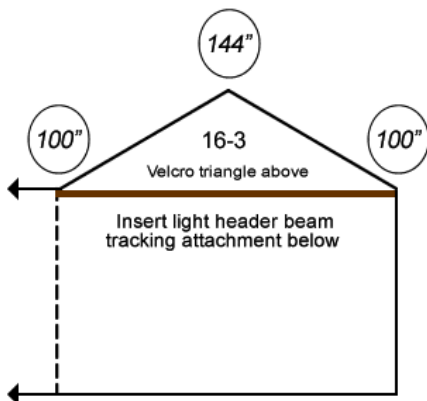

### Gabled Roof

Quite often, gabled roofs have a horizontal header beam below the gabled triangle.

If not, you can insert a lightweight header beam horizontally that is tall enough not to sag like an upright 2x6 depending on the width of the space.

# Measure Panel Widths

- Now that we've defined the over all exposure of the project, simply add your panel widths starting from the LEFT and working towards the RIGHT
- Wherever you create a panel break, you will have a doorway.
- Generally, 1 or 2 doorways will be plenty.
- Try to minimize the number of panels in your project to save cost and to have one less opening to seal.
- If you are using tracking, be mindful of how your curtains will swag when not in use.
- By mapping out the overall exposures and then defining panel widths, we'll have all the geometry we need.

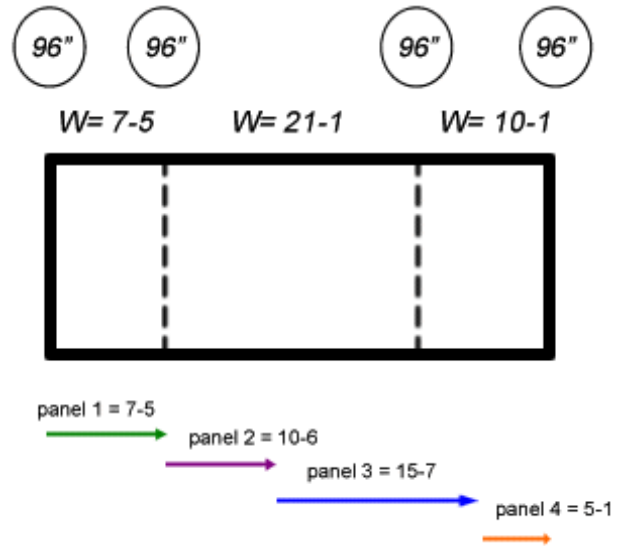
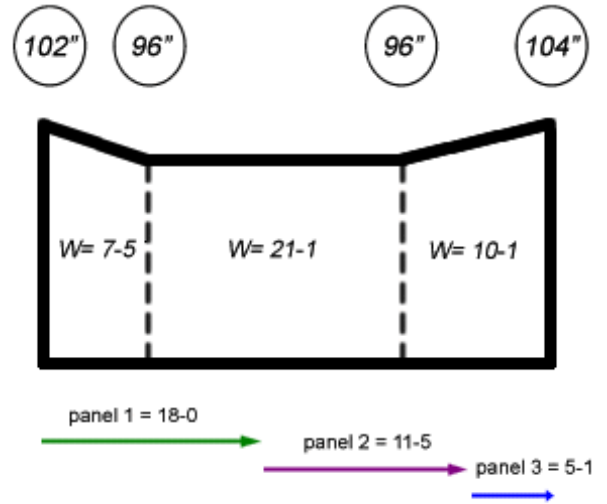

# Measurement Adjustments

## Width adjustments

1. Each side of a curtain panel that attaches to a WALL or to the INSIDE of a support column requires an extra 2 inches so that you can turn the binding inward for protective overlap.

If you can run the curtain to the furthest edge of a support column with no inward turn, terrific! With no inward turn, the extra adjustment won't be necessary. If an inward turn is required on both sides of the same curtain panel, you must double the adjustment to 4 inches.



*Inward turn*

2. Automatically, add 1 more inch to each curtain panel.

3. Add 1" per 10ft of curtain panel width (rounded). For example, if you are ordering a 34ft wide curtain panel and have made your adjustments for attachment, go ahead and add yet another 3 inches. (34 ft rounds to 30, divided by 10 = 3 inches).

## Height adjustments

Tracking requires no height adjustment since the 1 inch drop from the track will automatically give you a 1 inch overlap with the floor. If there is a slight slope that is less than 2", take the tallest height and consider your panel to be rectangular.

For Velcro® attachment, curtains should be at least 2" taller than your exposed opening. One inch at the top to attach the adhesive-backed Velcro® strip and another inch to overlap with the floor. If you plan to attach the top of your curtain well above the actual exposed opening, make the necessary adjustment so that you have an inch overlap with the floor.

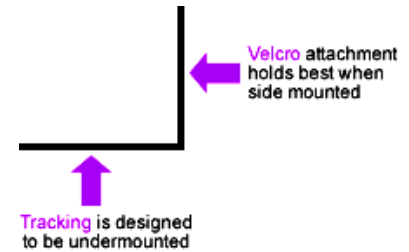

## Example:

Panel 1 makes 1 inward turn at the house  
 Panel 2 is measured to run past the column (no inward turns)  
 Panel 3 makes 2 inward turns both at the house & corner column

### Panel 1 Width:

18-4. measured + 2 in. (inward turn at the house)  
 + 1 in. (per panel) + 2 in. (18 rounds to 20/10 = 2) or 18-9.

### Panel 2 Width:

10-2 measured + 1 in. (per panel) + 1 in. (10/10 ) or 10-4.

### Panel 3 Width:

11-0. measured + 4 in. (2 inward turns)  
 + 1 in. (per panel) + 1 in. (8/10 rounded up) or 11-6

## Height:

For tracking attachment take the tallest height of 97in.  
 For Velcro® attachment order = 99in.

